



## THE HOUSE STORY

Comfort is key when you're at home, and we replicate the same solace at HOUSE. Perched atop Dempsey Hill, HOUSE is a 4,000 square-foot residence-gallery to everything that's visually stimulating. From plating to comforting, creative gastronomy that combine local flavours with the global palate to tease and please curious taste buds; to the lush woodland surrounds, and even the stunning works of art dotted around the property - HOUSE possesses the elements of a true multi-sensory experience.







# KUBRICK ROOM

HOUSE is made up of a main dining hall and 3 private rooms known as Kubrick, Karenina and Bette Davis.





# KUBRICK ROOM

Seating Capacity: 50-60pax

We are flexible with the arrangement in this room such as a semi-lounge and dining set-up for up to 50pax as demonstrated here. It may also service as an entertainment room.





# KUBRICK ROOM

Seating Capacity: 50-60pax

A clustered seating is recommended for 45pax and above.

This set-up was done by one of our clients using artificial flowers and battery-operated candles.





# KARENINA ROOM

Seating Capacity: 10-12pax

This is usually the bridal room and we will provide a portable mirror. If not in use, the client may opt to seat their guests in here.



# BETTE DAVIS ROOM

Seating Capacity: 20-25pax

This is a multi-purpose room which can be used to conduct tea ceremonies or where close family members can relax and kids can play.





# BETTE DAVIS ROOM

Seating Capacity: 20-25pax

We can convert this space into a dining room if the main hall is not sufficient to accommodate all your guests.



# OUTDOORS

This is where we will hold the solemnisation ceremony. We recommend a maximum audience of 30pax to be seated behind the solemnisation table.





# SOLEMNISATION CEREMONY

The chairs are arranged with a centre isle and facing out towards the greenery.



# SOLEMNISATION CEREMONY



A client laid out a red carpet along the isle and hung some garlands on the tree which serves as a backdrop.





# SOLEMNISATION CEREMONY

You have a choice of using the brown chairs, banquet chairs covered with a white cloth or these tall grey chairs. Do note that these chairs are subjected to availability.





# GUESTS RECEPTION

A reception table can be arranged under one of our tents at the entrance of the restaurant.





# GUESTS RECEPTION

We can also set it up in front of our restaurant signage on a welcome carpet.





# GUESTS RECEPTION

A client keeping in line with the retro theme through their wedding favours.





# GUESTS RECEPTION

Our outdoor tents are filled with metal grills that come in handy for photo displays.

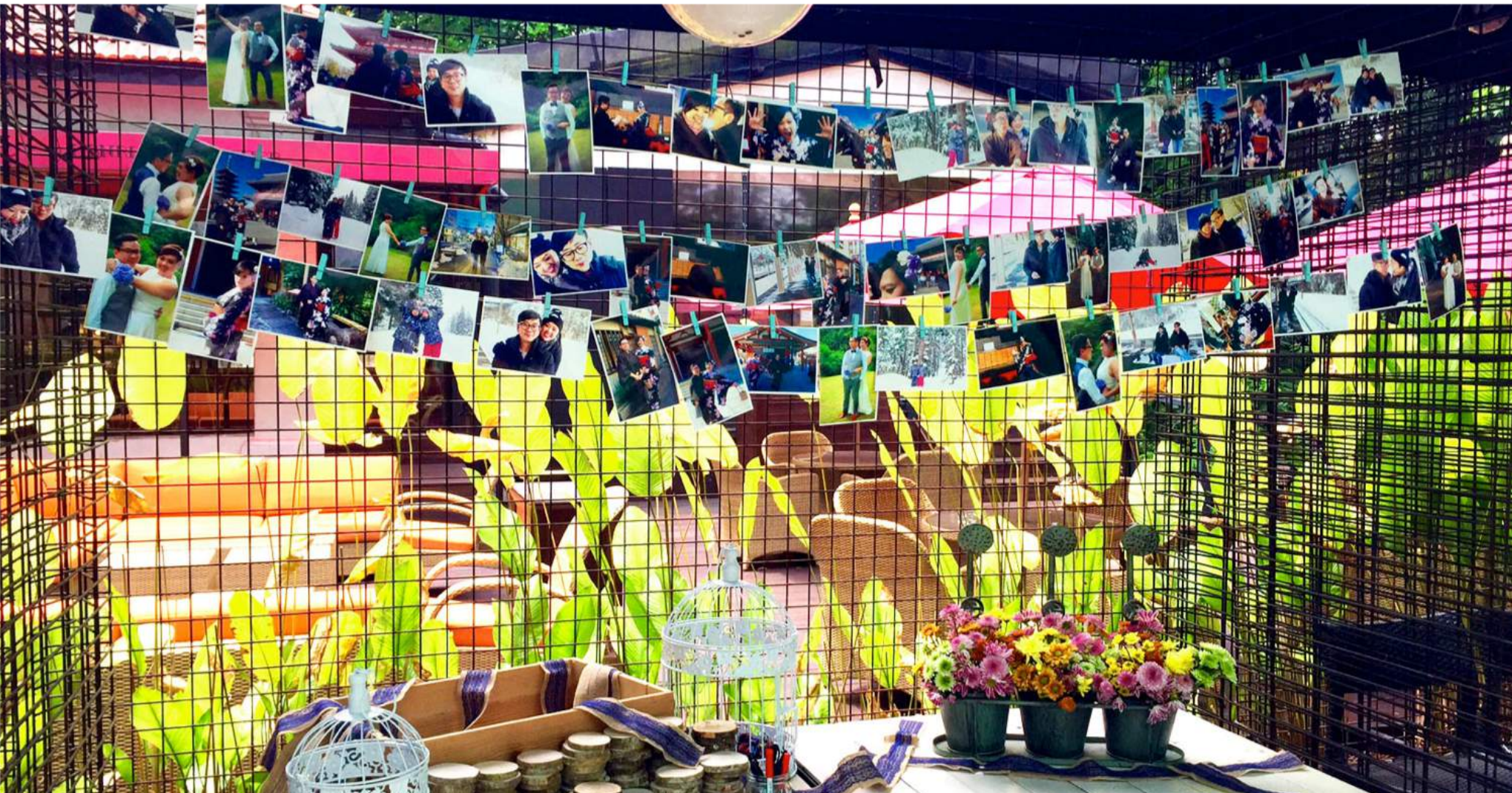



# GUESTS RECEPTION

An indoor set-up of some photos and the guests book.





# BUFFET LINE

The main buffet line is arranged at the front of the restaurant on a long table which sits 20pax.





# BUFFET LINE

Alternatively, we can also set-up the buffet line against the windows.

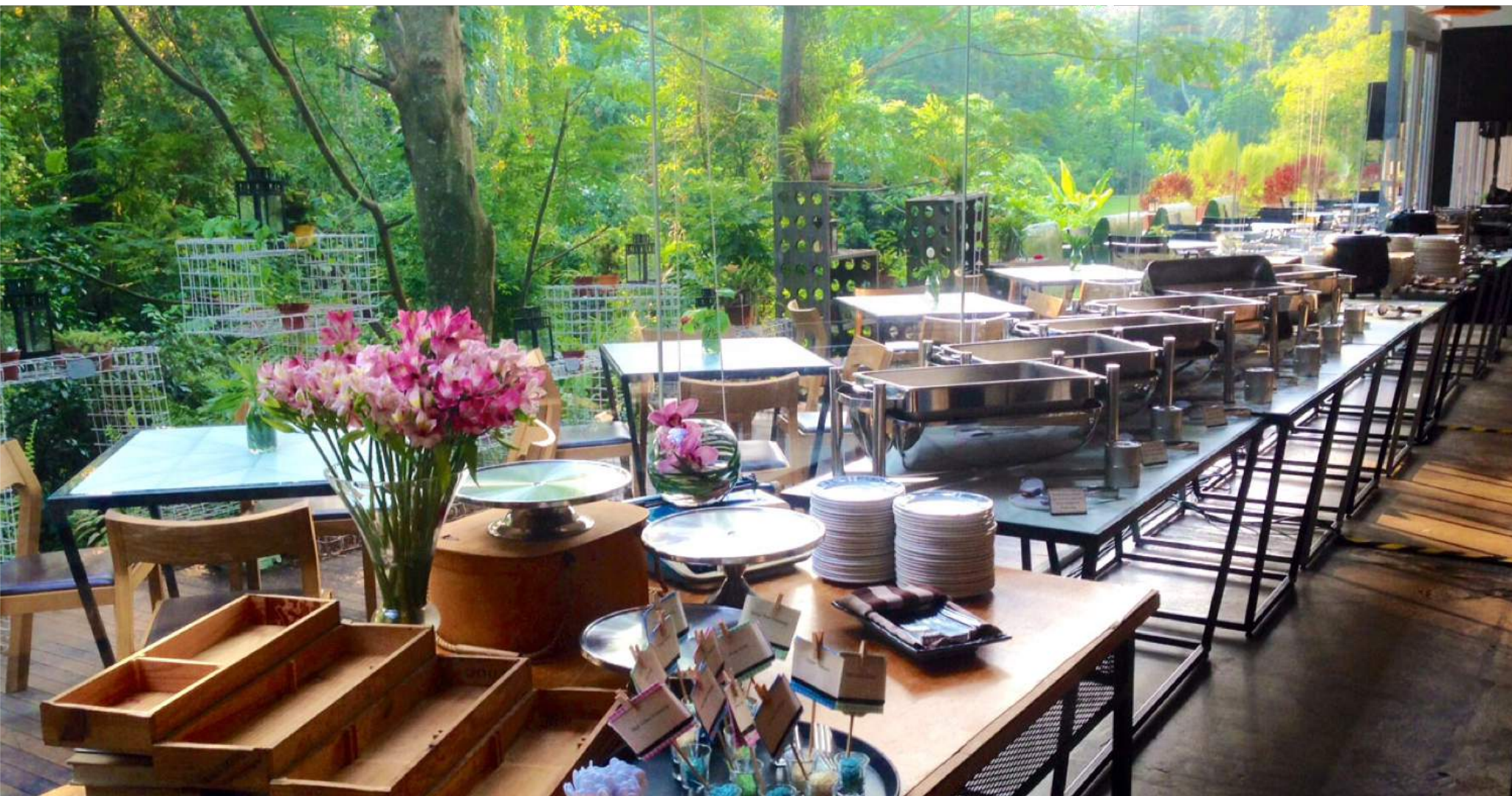



# BUFFET LINE

The buffet line is split into 2 sections. Half of the table is occupied by the mains in chaffing dishes as shown in the previous picture and the other half of the table is occupied with the soup, salad and the appetiser. Shown in this picture is the charcuterie platter and mixed salad.





# BUFFET LINE

A display of the mixed baby romaine with dressing and condiments.





# BUFFET LINE

Roasted pumpkin and pinenuts with sliced baked honey ham and cheese served with semi-dried tomato and honey mustard dressing.





# BUFFET LINE

Fancy some finger food for your guests? Here is a display of our wild truffle mushroom pizza, squid ink Skinny Pizza, mixed grilled vegetable sandwich, Vietnamese spring roll and roasted beef sandwich.





# SANDWICH BAR

Freshly toasted bread with a choice of chicken, beef, mushrooms and mixed vegetables.





# BUFFET LINE

You may choose to include free-flow coffee/tea and basil lemonade as part of the package.





# DESSERT TABLE

There are 3-4 desserts in each menu. You may choose to add on a couple more or retain what is offered as part of the menu.





# DESSERT TABLE

Double chocolate tart, gula melaka, cheese platter, cranberry cheesecake, lime cheesecake.





# INTERIOR SET-UP

All tables next to the glass windows are joint to sit 6-7pax across 2 sets of tables.





# INTERIOR SET-UP

You may choose to set the tables with white table cloths or do without them.





# INTERIOR SET-UP

This is part of the main dining hall marked as HOUSE B in floor plan.





# INTERIOR SET-UP

Kubrick Room. All flowers, serviettes and table runners were provided by the couple.





# TABLE SETTING

Flowers and wedding favors provided by the couple and placemats provided by HOUSE.





# TABLE SETTING

You may choose to print your own placemats like what this couple did, completed with their Instagram hashtag.





# HOUSE FLOOR PLAN

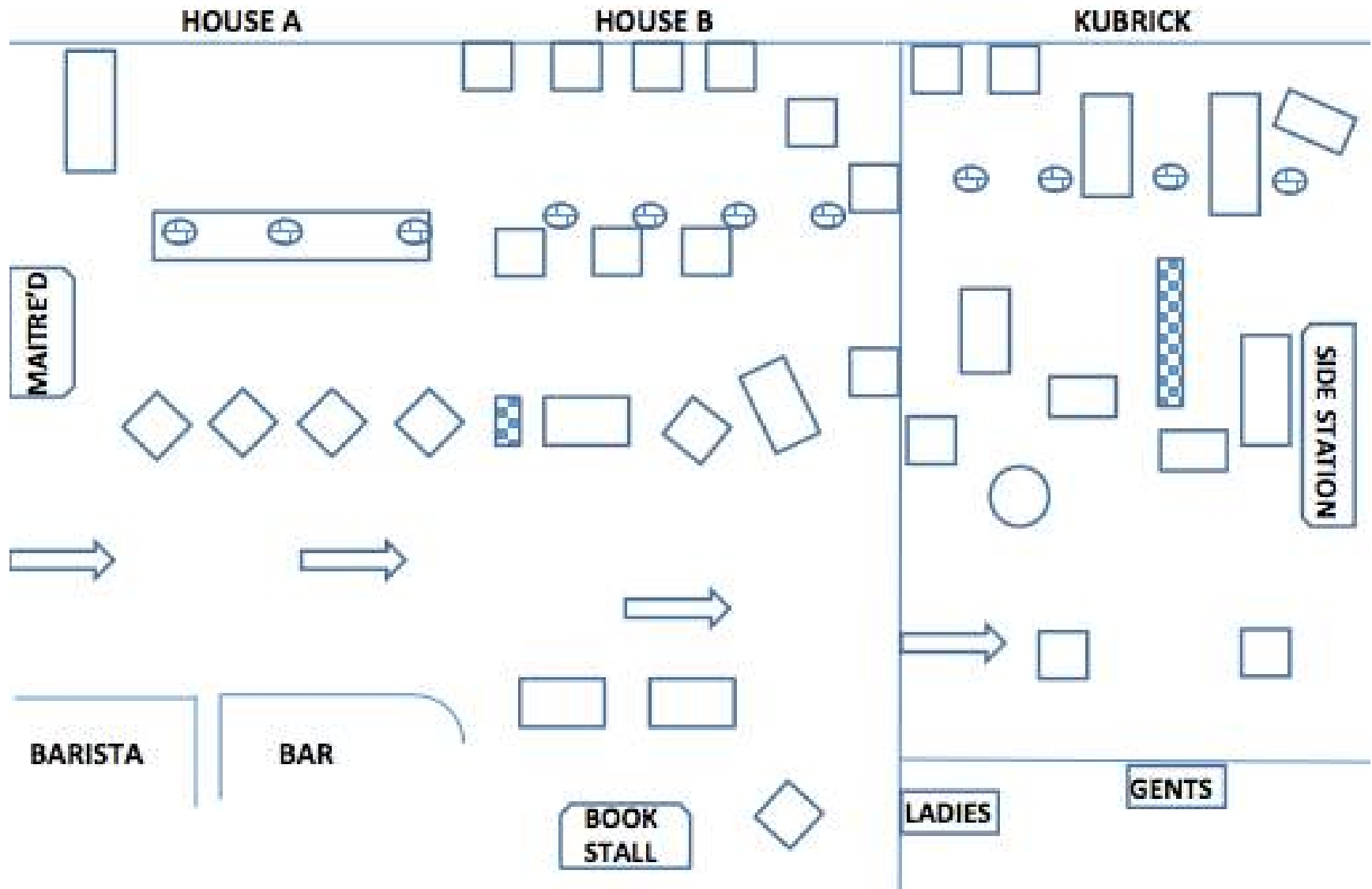



# HOUSE FLOOR PLAN

A common set-up with the tables joint up.

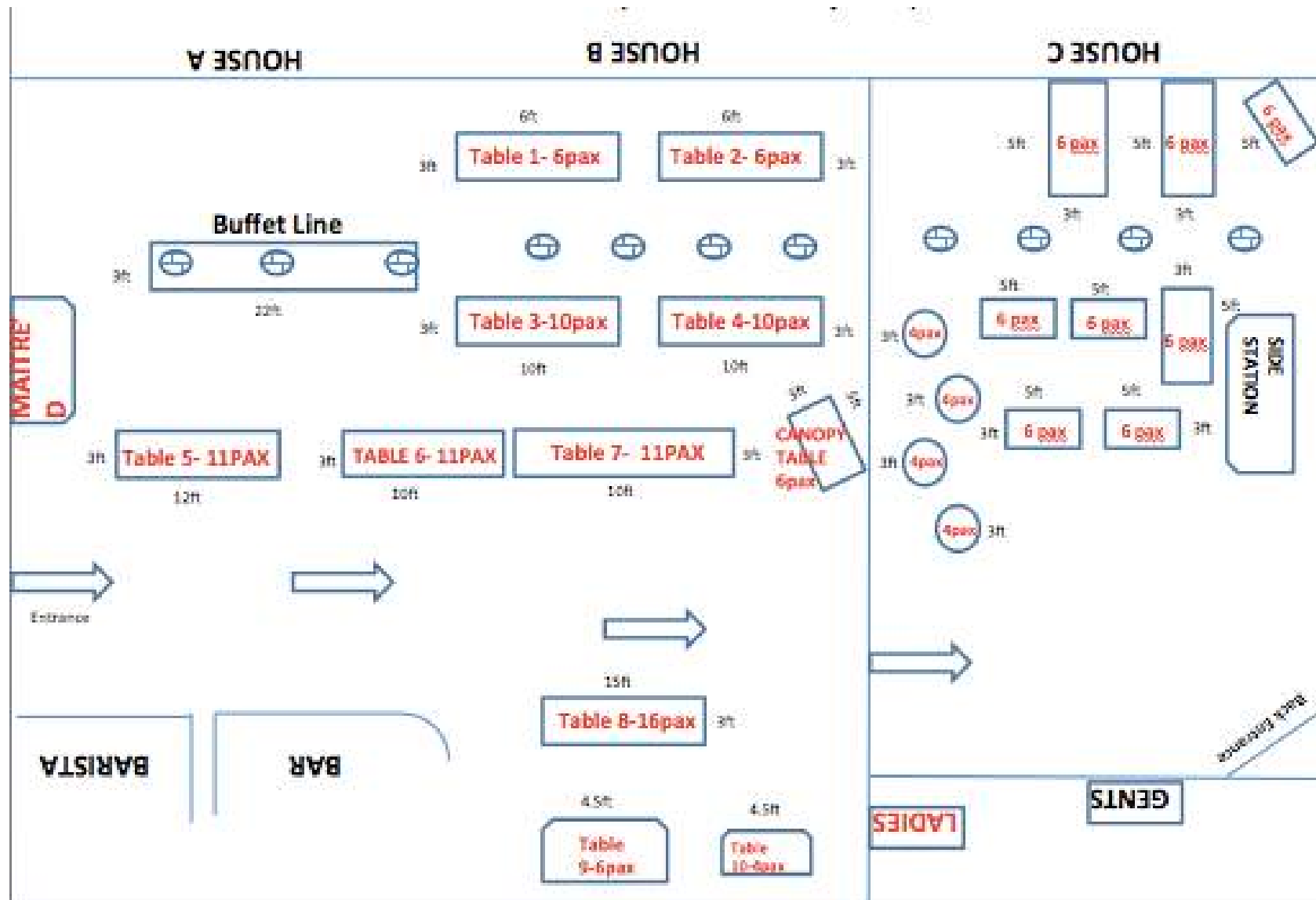



# HOUSE FLOOR PLAN

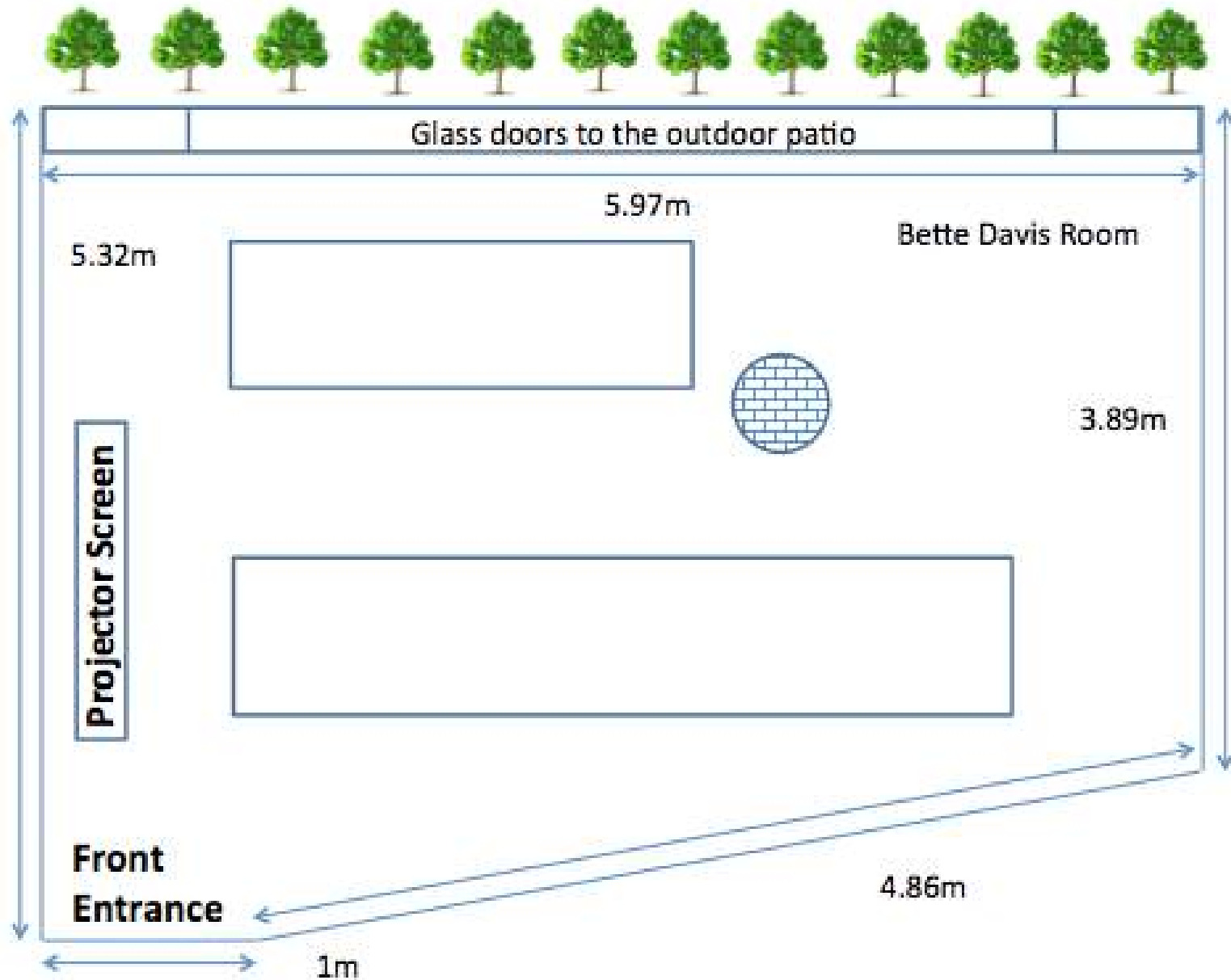



# Jonning and Alice:

“ Our wedding was simple, relaxed, fuss-free, and casual. We wanted the guests to mingle around instead of just sitting with people that they are familiar with. It's a gathering of friends and family members - people whom we genuinely want to share the special day with. ”

Our clients shared the same sentiment when asked why HOUSE?  
Our team is grateful to be give the opportunity to execute their vision in line with the restaurant's concept.





Thank you for perusing and we look forward to hosting you one day!



 **HOUSE**